

PLAN

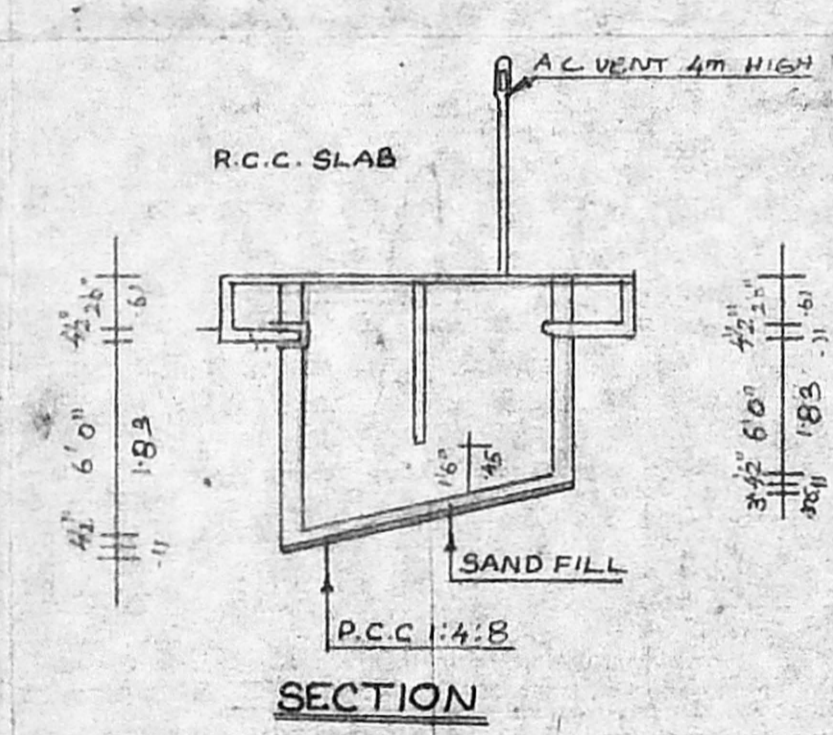

SECTION

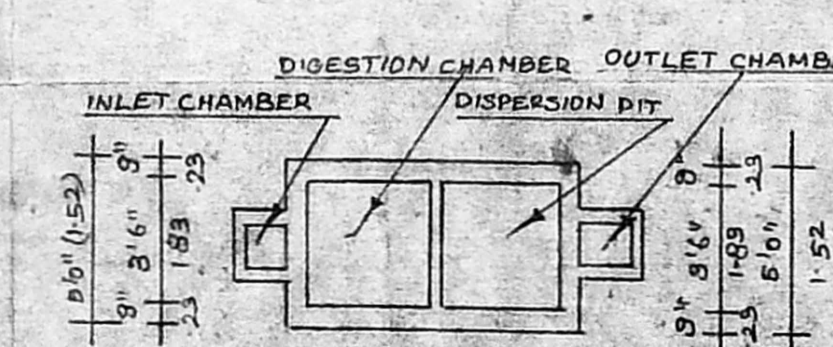

DETAILS OF SPETIC TANK

MADA 'C' / PP NO. /
 C.N. No. 22/12.852/54
 Part I 5/11/22 OPEN FIELD
 Part II
 R.P. dt. 15/12/54

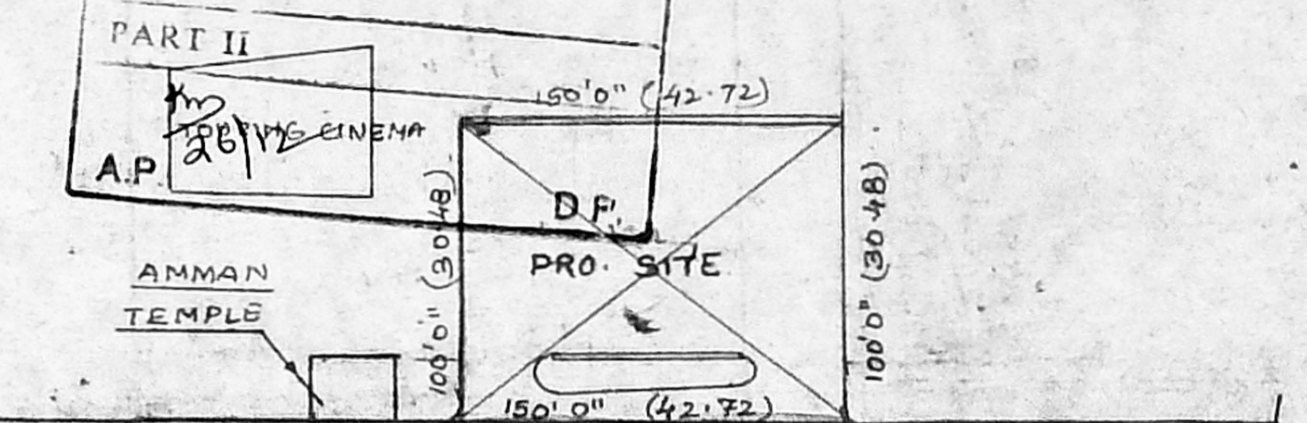

APPRO
 SUBJECT TO KEY PLAN N.T.S.
 THIS
 No. 22/12.852/54 - 1-95
 FOR MEMBER SECRETARY
 MADRAS METROPOLITAN
 DEVELOPMENT AUTHORITY
 MADRAS - 600 008

PLAN SHOWING THE CONSTRUCTION OF
 PROPOSED M.S./N.S.D RETAIL OUTLET
 OF M/s V. KRISNAMURTHY & SONS AT
 OLD S.N. 1110 OF VILLAGE N. 84,
 MADHAVARAM VILLAGE, SAIDAPET TALUK,
 CHENNAI M.G.R. DISTRICT.
 SCALE 1" = 8'0"

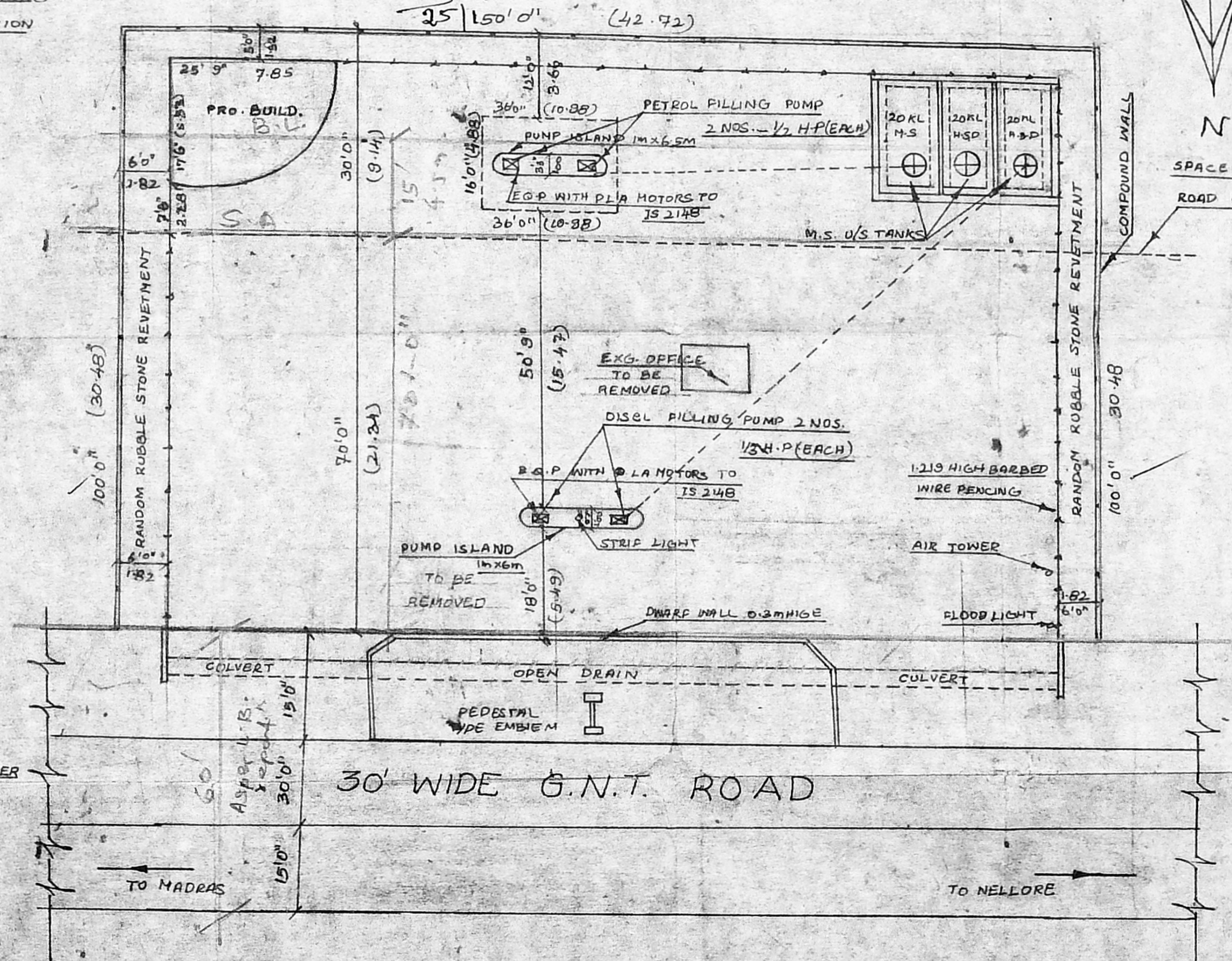

SITE PLAN SCALE 1" = 32'0"

INSTALLATIONS

COMPRESSOR - 1/2 H.P.	0.50
DISEL FILLING PUMP 2 NOS. - 1/2 H.P. (EACH)	1.00
PETROL FILLING PUMP 2 NOS. - 1/3 H.P. (EACH)	0.60
TOTAL	2.10

JOINERY DETAILS

D1 DOOR	4'6" x 7'6"	1.22 x 2.13
D2 DOOR	3'0" x 7'6"	0.91 x 2.13
S.W. SHOW WINDOW	2'6" x 4'0"	0.61 x 1.22
W WINDOW	4'0" x 4'0"	1.22 x 1.22
V VENTILATOR	2'6" x 1'6"	0.75 x 0.45

AREA DETAILS

SITE AREA	1393.55 M ²
GROUND FLOOR AREA	44.78 M ²
F.S.I. RATIO	0.032

COLOUR INDEX

PROPOSED	[Symbol]
ROAD	[Symbol]
BOUNDARY	[Symbol]
EXISTING	[Symbol]

V. Venkataraman
OWNER

V. Venkataraman
 ER. V. VENKATARAMAN, D.C.E.
 LICENSED SURVEYOR
 CLASS II No. 87 90-91.
 CORPORATION OF MADRAS
 113, MADHAVARAM HIGH ROAD,
 PERAMBUR, MADRAS-11
LICENSED SURVEYOR